

Subminiature, Flush Diaphragm Pressure Transducers

Model S

150 TO 20,000 psi

FLUSH DIAPHRAGM

HIGH FREQUENCY



Model S

Our full line of subminiature pressure transducers accurately measure pressure ranges from 150 psi to 20,000 psi. These subminiature pressure transducers have a high natural frequency and utilize a flush diaphragm.

Temperature compensation is accomplished by using temperature sensitive components located inside the transducers. These transducers have a small electrical zero balance circuit board which is in the lead wire (approximately 1" X .087" thick). This balance board does not have to be the same temperature as the transducers. All units have four (4) active bonded strain gages arranged in a Wheatstone bridge configuration.

Dimensions

Model S

Available Pressure Ranges*

150; 200; 300; 500; 750; 1000; 1500;
2000; 3000; 5000; 7500; 10,000; 15,000; 20,000 psi

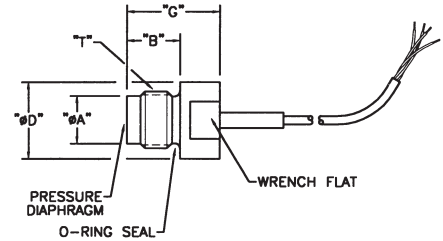

Order Code	"T" Thread	"A" Dia.	"D" Dia.	"B"	"G"	Diaphragm
BP357	3/8-24 UNF	.310	.50	.45	.69	Welded
BP358	7/16-20 UNF	.375	.56	.50	.75	Welded

*Stocked units (bold face print) available with 3/8- 24 UNF thread only. 3/8-24 UNF thread is only available on ranges 15,000 psi. Consult factory for ranges below 150 psi.

Installation

Standard "S" type transducers have straight threads and use an O-ring for pressure sealing. To get the best seal with the O-ring on the transducer, the tapped hole should have the dimensions shown below. For normal operating temperatures (-65° F to +250° F) use BUNA-N (black) O-rings. For high temperatures (250° F to 425° F) use silicone rubber (red).

"T"	"A"	"B"	"D" ^{+0.000"} _{-.002"}	O-Ring	Max. Torque (For 17-4 PH only)
3/8 - 24 UNF	.47"	.30"	.445"	#11	300 In-lbs.
7/16 - 20 UNF	.54"	.36"	.504"	#12	500 In-lbs.

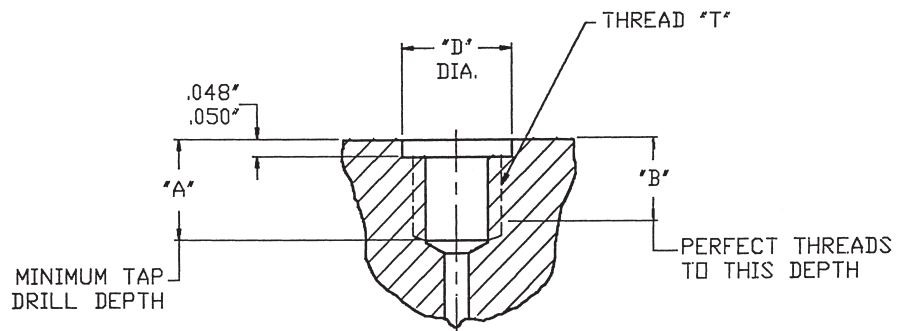

		Model S
PERFORMANCE	Pressure Ranges.....	$\frac{3}{8}$ -24 UNF Thread: 150 to 15,000 psi (10 bar to 1050 bar) $\frac{7}{16}$ -20 UNF Thread: 150 to 20,000 psi (10 bar to 1375 bar)
	Non-Linearity and Hysteresis (max)	1.0% F.S.
	Non-repeatability (max)	+ /-0.1% F.S.
	Output (standard)	2mV/V
	Resolution	Infinite
ENVIRONMENTAL	Temperature, Operating	-65° to 300° F (-54° to 150° C)
	Temperature, Compensated	60° to 160° F (15° to 70° C)
	Temperature Effect	
	-Zero (max).....	.01% F.S./° F (0.018% F.S./° C)
	-Span (max).....	.02% Rdg./° F (0.036% Rdg./° C)
ELECTRICAL	Strain Gage Type	Bonded foil
	Excitation (calibration)	5VDC
	Bridge Resistance	350 ohms
	Wiring Code (std)	#1 (See Pg. AP-7)
	Electrical Termination (std)	4 twisted leads (5 ft.)
MECHANICAL	Media	Gas, Liquid
	Overload-Safe	50% over capacity
	Wetted Parts Material.....	17-4 PH Stainless
	Type (Gage, Abs.).....	Gage
	Case Material	17-4 PH Stainless

Options (See Appendix)

Temperature compensated 1b, 1c

Premium Options: 1d, 1e, 1g, 1h, 1i

Custom threads, metric threads, underwater cable, microtech connector, special headers and 400° F (200° C) temperature are available on some models and ranges, consult factory.

Accessories: Mating connectors and connector/cable assemblies

General Information

How to order (See Pg. AP-19)

Gage/Absolute pressure selection flow chart (See Pg. PR-1)

●お問い合わせは下記へ—

株式会社クローネ 私達は機能・品質・デザインを追究します。

■ 本 社： 〒124-0023 東京都葛飾区東新小岩3丁目9番6号
TEL: (03) 3695-5431 / FAX: (03) 3695-5698

■ 大阪支店： 〒530-0054 大阪市北区南森町2-2-9 (南森町八千代ビル7F)
TEL: (06) 6361-4831 / FAX: (06) 6361-9360